

3/4" ANTISIPHON VALVE

TECHNICAL FEATURES

- Maxim pressure.....15 bar @ 20°C
- Connection3/4" /(optional 16mm)
- Materials: BodyPP
- Ball.....PP
- O-ring..... FPM /(optional EPDM)

Dimensions: Antisiphon 3/4"

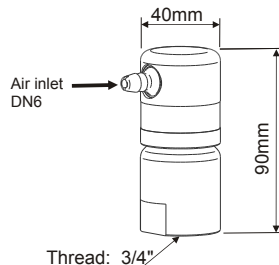

3/4" Antisiphon

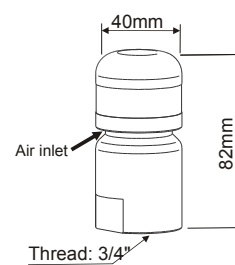

INSTALLATION AND OPERATION

Floating ball principle:

A PP floating ball keeps the air inlet sealed while the liquid fills the discharge pipe. When this is depressurized the valve let air getting into the pipe avoiding product suction due to the siphon effect.

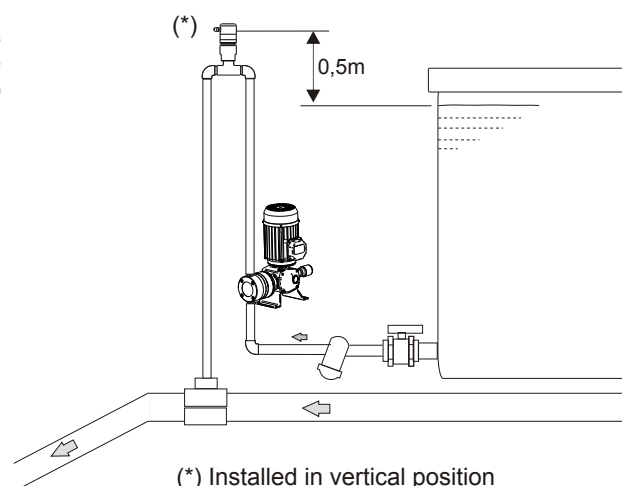
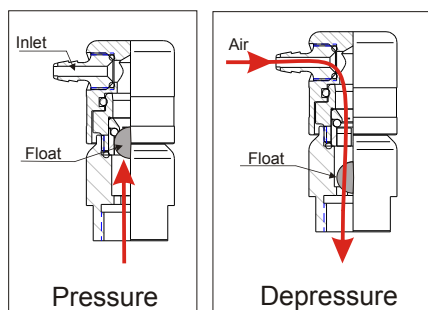

LIST OF PARTS

3/4" ANTISIPHON VALVE

18-840-P

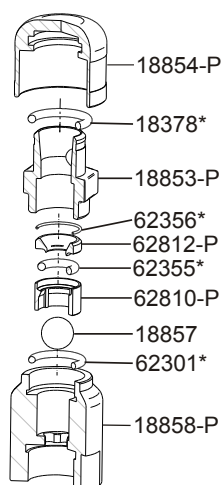

3/4" 6X12 ANTISIPHON VALVE

18-841-P

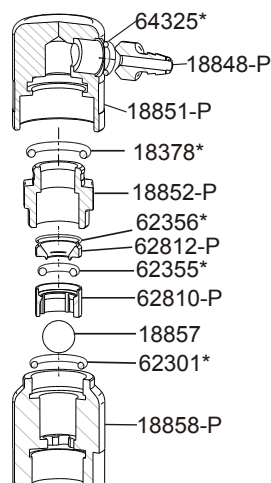

OPTIONAL ACCESSORIES

"Y" fitting 16mm- 3/4"

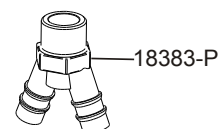

* Optional o-rings in IEPDM

* Optional o-rings in IEPDM