

3/4" ANTISIPHON VALVE



ACC 003

TECHNICAL FEATURES

Maxim pressure.....15 bar @ 20°C
Connection3/4" //(optional 16mm)
Materials: BodyPP
 Ball.....PP
 O-ring..... FPM //(optional EPDM)

Dimensions: Antisiphon 3/4"

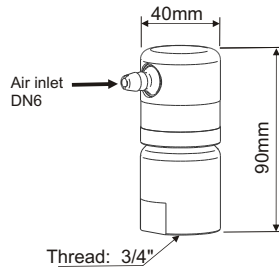

3/4" Antisiphon

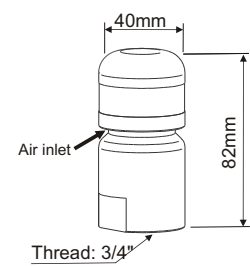

INSTALLATION AND OPERATION

Floating ball principle:

A PP floating ball keeps the air inlet sealed while the liquid fills completely the discharge pipe. When this is depressurized the valve let air getting into the pipe avoiding product suction due to the siphon effect.

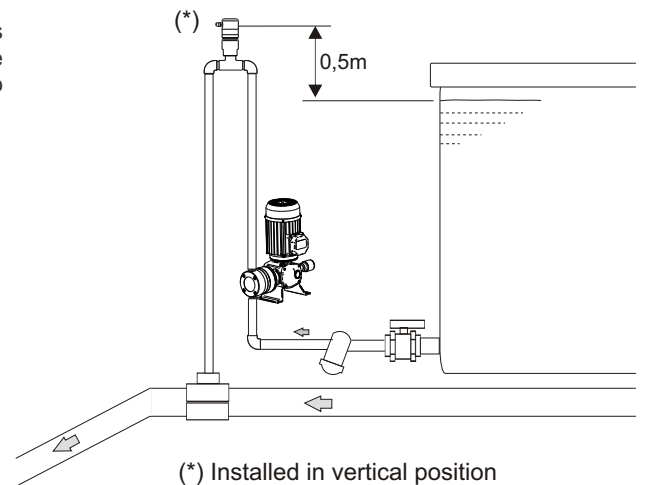
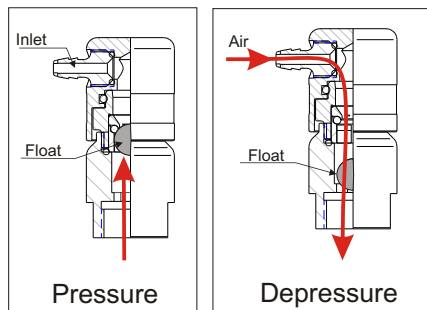

LIST OF PARTS

3/4" ANTISIPHON VALVE 18-840-P

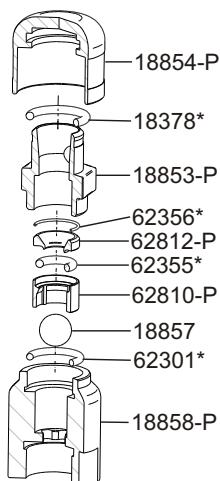

* Optional o-rings in IEPDM

3/4" 6X12 ANTISIPHON VALVE 18-841-P

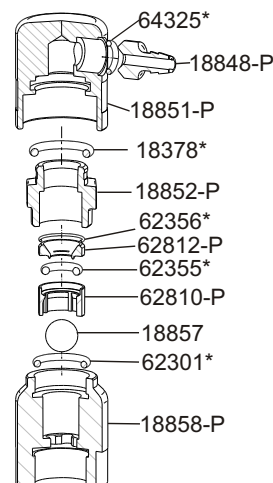

* Optional o-rings in IEPDM

OPTIONAL ACCESSORIES

"Y" fitting 16mm- 3/4"

