

SUCTION LANCE 3/4"

CODE

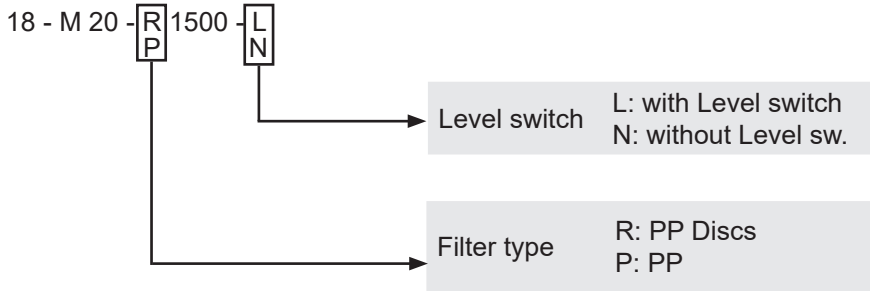

SUCTION LANCE 3/4 WITH DISC PP FILTER

Technical features

| | |
|------------------------|-----------------------|
| Connection: | 3/4" |
| Materials: | PP / FPM / PVC/ Glass |
| Hole diameter in tank: | 26 - 30 mm |
| Suction line: | DN20 (Dext.25) |
| L: | 1500mm |
| Foot valve with filter | |
| Mesh: | 120 |

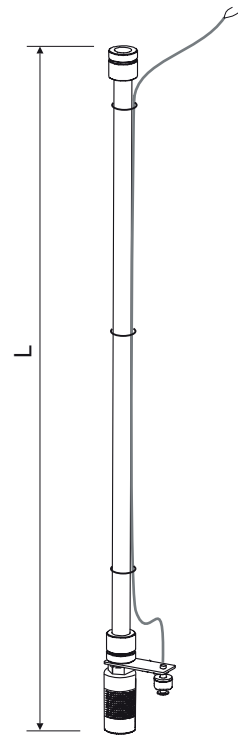

List of parts

18-M20-R1500-L Suction lance 3/4" with disc PP filter

| | |
|-----------------|---|
| 60872-P | Suction lance 25x3/4 connection |
| 18-830-P | Foot valve 3/4 with filter |
| 18311 | Switch level sensor |
| 60370 | 25X3.5 o-ring |
| 60871 | Suction line DN20 D25 L1500 |
| 60873-P | Suction lance female connector 25x3/4 |
| 60875 | Float level switch support |
| 62300 | 19X3 FPM o-ring |
| 64309 | 21X2.5 FPM o-ring |
| 18-834-P | Foot Valve 3/4 with PP disc filter for lance |

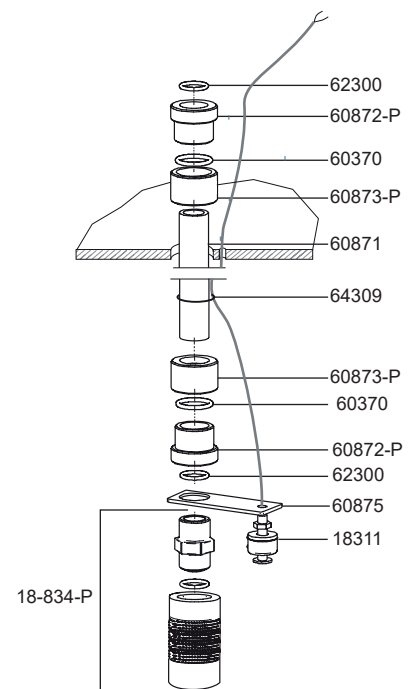

SUCTION LANCE 3/4 WITH PP FILTER

Technical features

| | |
|------------------------|------------------------|
| Connection: | 3x4" |
| Materials: | PP / FPM / PVC / Glass |
| Hole diameter in tank: | 26 - 30 mm |
| Suction line: | DN20 (Dext25) |
| L: | 1500mm |
| Foot valve with filter | |
| Mesh: | 30 |

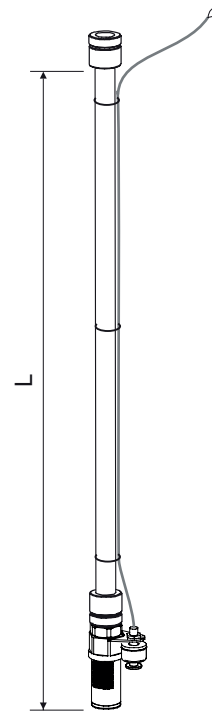

Referencia

18-M20-P1500-L Suction lance 25x3/4" with PP filter

60 872-P Suction lance 25x3/4" connection

18-830-P Foot valve 3/4" with PP filter

18311 Switch level sensor

60370 25X3.5 o-ring

60871 Suction line DN20 D25 L1500

60873-P Suction lance female connector 25X3/4

62300 19X3 FPM o-ring

64309 21X2.5 FPM o-ring

